

Loading Bay Equipment

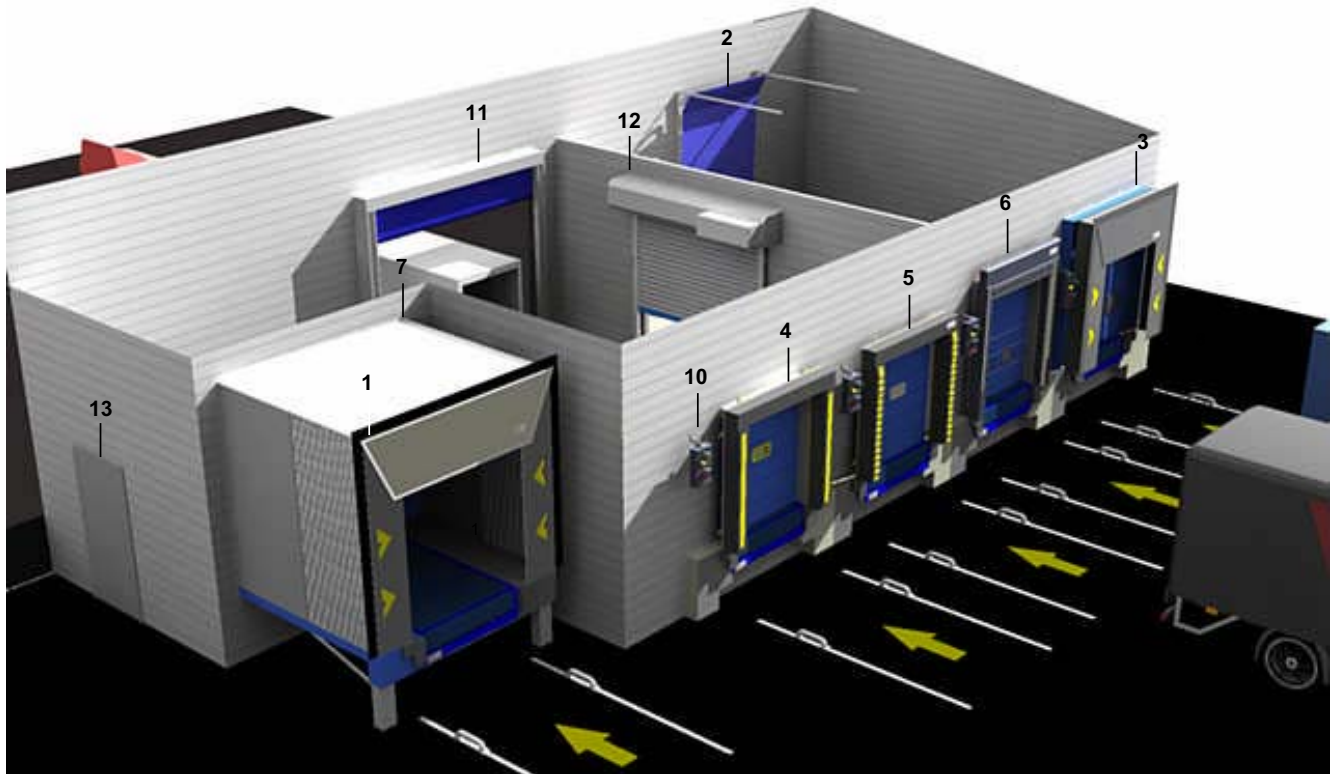

Product Key

- | | | | |
|---|--|----|----------------------|
| 1 | Range of Dock Levellers | 8 | Wheel Guides |
| 2 | Sectional Overhead Door | 9 | Dock Buffers |
| 3 | Curtain Dock Shelter | 10 | Traffic Lights |
| 4 | Foam Cushion Dock Seal | 11 | High Speed Door |
| 5 | Foam Cushion Dock Seal with Adjustable Top Curtain | 12 | Roller Shutter |
| 6 | Inflatable Dock Shelter | 13 | Steel Fire Exit Door |
| 7 | Loading House | | |

From Design to delivery we offer the complete package

Swing Lip Dock Leveller

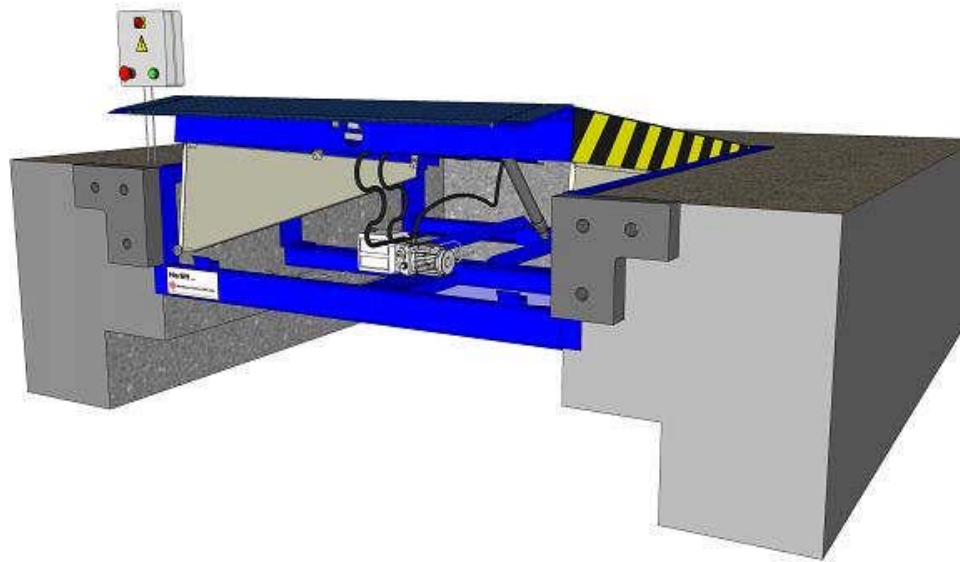

Dock Leveller with a 400mm Swing Lip. The solution to most docking situations. Once the lorry is in the dock position. The dock leveller compensates any difference in height between the dock and lorry deck, This is achieved by the person operating the Dock Leveller pressing the control panel button. The Dock Leveller rises to its highest point and the lip extends outwards.

The Dock Leveller then lowers until the hinged lip rests upon the vehicle dock. Any goods / materials can now be safely unloaded or loaded, when unloading or loading is complete, the person operating the Dock Leveller presses the control button again and the Dock Leveller retracts back into its original position. The vehicle is now able to drive away.

Features

- Fully compliant with European directive EU 1398.
- Available in various RAL colours to suit clients - blue painted Ral 5003
- Optional insulation under platform.
- Fully welded self supporting frame.
- Power supply: 380V/3 phase
- Electric commands in accordance CEI IP55 rules
- Control panel with up/down/stop, security stop, main power stop buttons
- Electrical engine power : 0.55kw

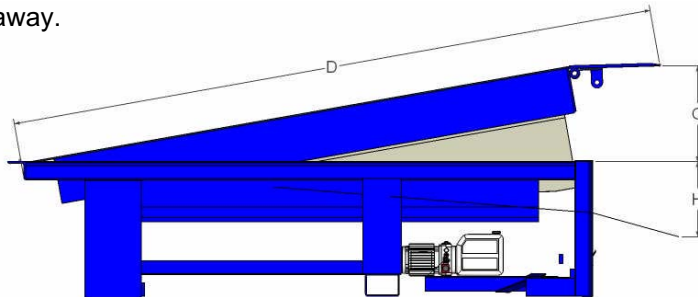

DOCK LEVELLERS mod. KRBA								
Standard models								
Type	External sizes			Lip Length	Excursion pos. neg.	Weight Kg.	Concentrated Load	Distributed Load
	width (E)	Length (A)	H.					
KRB 1a	1.500	2.000	600	400	260-676/286	800	6.000	9.000
KRB 1b	1.800	2.000	600	400	260-676/286	900	6.000	9.000
KRB 1c	2.000	2.000	600	400	260-676/286	1.000	6.000	9.000
KRB 1d	2.200	2.000	600	400	260-676/286	1.200	6.000	9.000
KRB 2a	1.500	2.500	600	400	273-680/296	900	6.000	9.000
KRB 2b	1.800	2.500	600	400	273-680/296	1.000	6.000	9.000
KRB 2c	2.000	2.500	600	400	273-680/296	1.100	6.000	9.000
KRB 2d	2.200	2.500	600	400	273-680/296	1.200	6.000	9.000
KRB 3a	1.500	3.000	600	400	335-734/335	1.000	6.000	9.000
KRB 3b	1.800	3.000	600	400	335-734/335	1.100	6.000	9.000
KRB 3c	2.000	3.000	600	400	335-734/335	1.200	6.000	9.000
KRB 3d	2.200	3.000	600	400	335-734/335	1.300	6.000	9.000

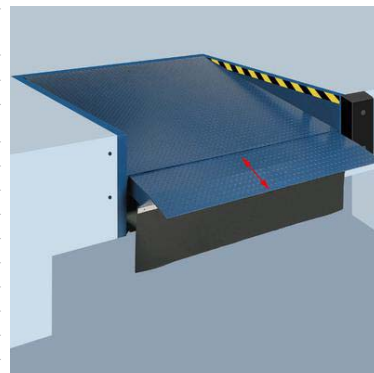

Telescopic lip available for option by clients

Controls and Loading Bay Accessories

Dock Levelers can be supplied with various types of control panels and loading bay accessories. see below for the options available.

Basic Control Panel

Used with the hinged lip dock leveler, one button operation control switch. Dock door operating buttons are also available with this control panel

Telescopic lip panel

Same as the basic control panel but with additional buttons to operate the telescopic lip. One button extends the lip out, the other retracts the lip.

Loading Bay Accessories

Traffic Lights

Traffic light are used to inform the vehicle driver that the vehicle is correctly docked & when it is safe to drive away. Manually operated or interlocked with the control system.

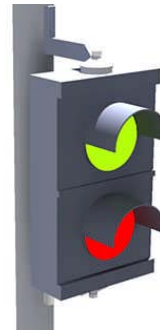

Dock Light

Designed to illuminate the inside of the docked vehicles. Halogen lamp fixed to a flexible galvanized steel arm. Allows the user to move into required position for safe loading or unloading.

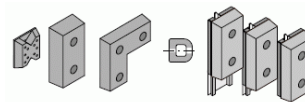

Dock Rubber Seals

A variety of rubber buffers are available for protection of the loading bay.

(Please consult our sales engineers size and type).

Wheel Guides

To guarantee the vehicle approaches the correctly and in turn allowing the vehicle to back against the dock shelter centrally ensuring a good seal.

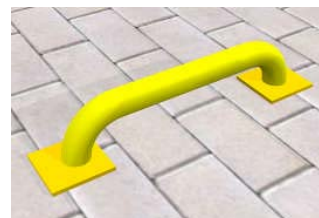

Methods of Installation

Option 1

Pit edge angles with suspended frames.
A Concrete pit is prepared by others with the angles cast into the pit (ASTECH can supply the angles in advance of casting the pit). The Dock Leveller is then lowered into position and welded.

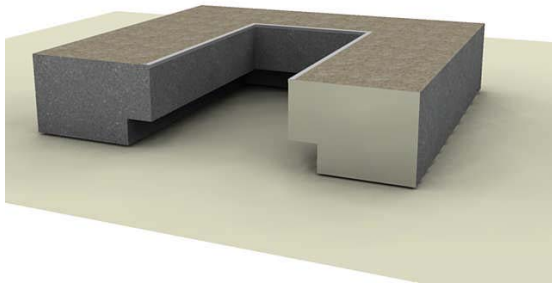

For pit construction details please request ASTECH technical drawing details.

Option 2

Mounted from steel dowels.
A concrete pit is prepared by others with embedded steel dowels. The dock leveller is then lowered into position and welded to the steel dowels.

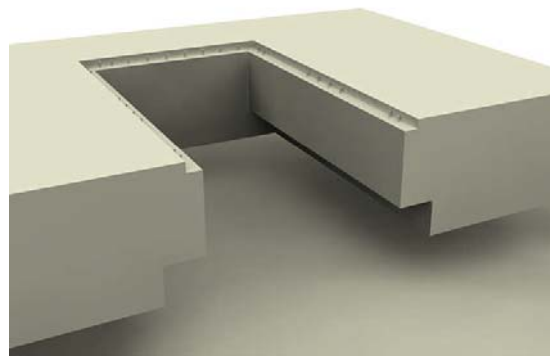

For pit construction details please request ASTECH technical drawing details.

Option 3

Closed pit frame.
A concrete pit is prepared by others with a steel angle frame. The dock leveller is then lowered into position & welded to the angles.

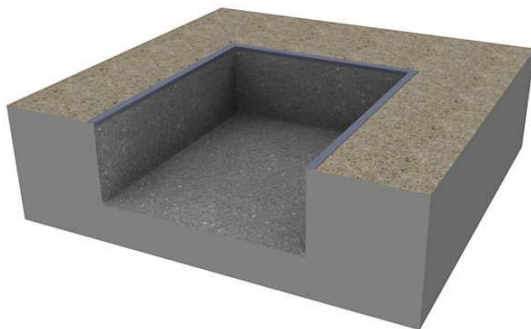

For pit construction details please request ASTECH technical drawing details.

Option 4

Box Model
The dock leveller is placed within a box and in turn used in lieu of shuttering, contracting by others.

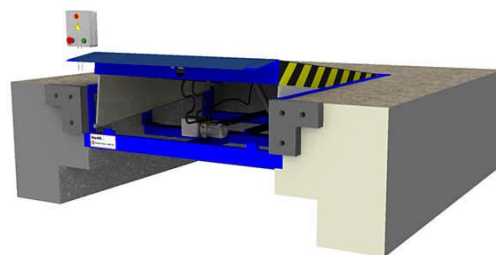

Inflatable Dock Shelter Mod.KDG-R

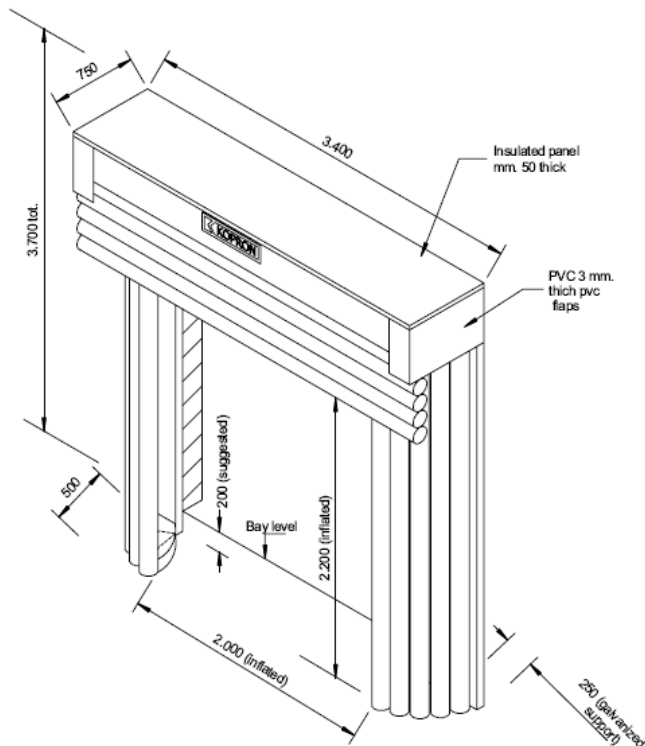

Inflation dock shelter designed for any type of vehicle. Ideal for low temperature controlled environments such as cold store, food preparation, factories, warehouses etc. The vehicle reverses into the Dock Shelter with the dock shelter deflated, once the vehicle is stationary the person operating the shelter presses the button and the shelter inflates within approx 15 second the shelter is fully inflated, making a tight seal around the top

Features

External dimension: 3400mm width x 3700mm height x 750mm deep

The inflation dock shelter is made by two vertical and one upper inflation seals in polyester travira fabric, laminated on both side with PVC coating. Dark blue color Ral 5003

Dock shelter supply with an electrical 3 phase blowing moter equipemt inclose stop/start switch

Approx inflation time 15 secs

Vehicle guidance markings

Standard control panel with on/off switch

Level access option

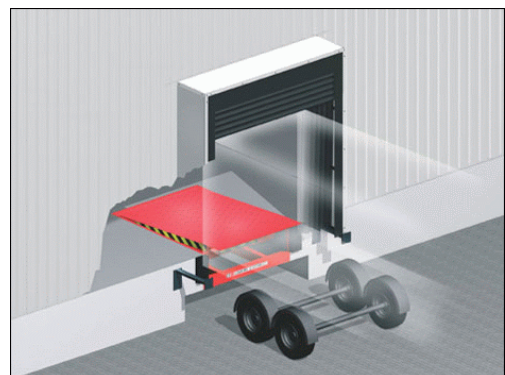

Curtain Dock Shelter KDR

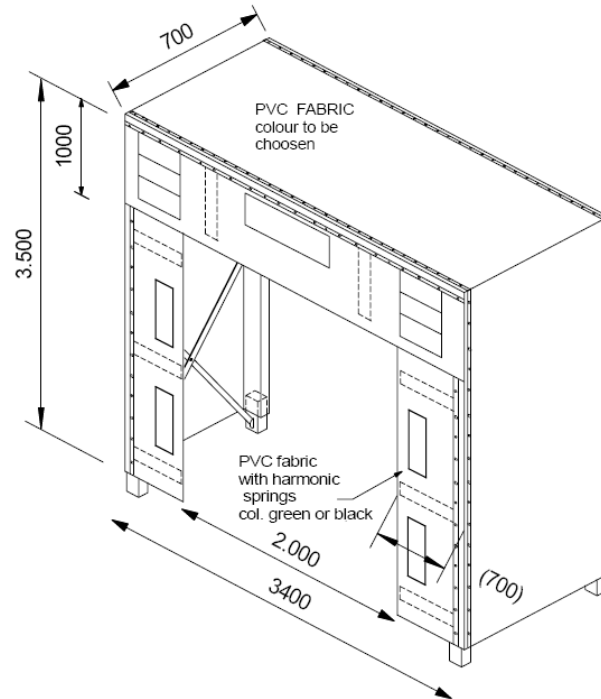

External dimension: 3400mmW x 3500mmHx 700mmD

We offer a comprehensive range of Dock Shelters and Seals to suit the clients particular application. Ensuring goods are loaded and unloaded in a clean and dry condition, providing a temperature controlled environment, and thus keeping the energy loss to a minimum. Framework framed from galvanized steel profiles with hinged arms, which allows the shelter to retract and form a tighter seal. When the vehicle has docked the curtains are pushed clear of the docking area, allowing clear access to the vehicle for safe loading or unloading.

Features

Hot galvanized steel frame 4.5 nominal thick black Vinyl polyester wear resistant top/side flaps

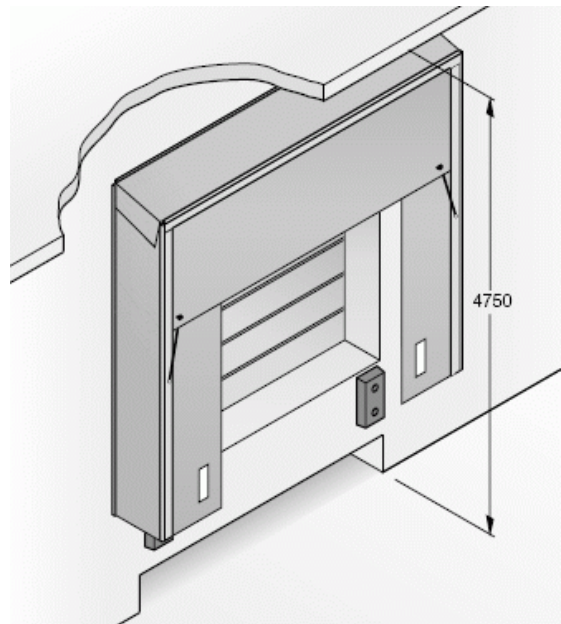

Range of Loading Houses

Designed as an extension to an existing warehouse or factory, allowing owners to fully utilize the building production or storage space. Each loading house is provided with its own unique docking system to suit the clients application and environment. The loading house is supplied with a self supporting steel pedestal and a steel frame for different types of cladding.

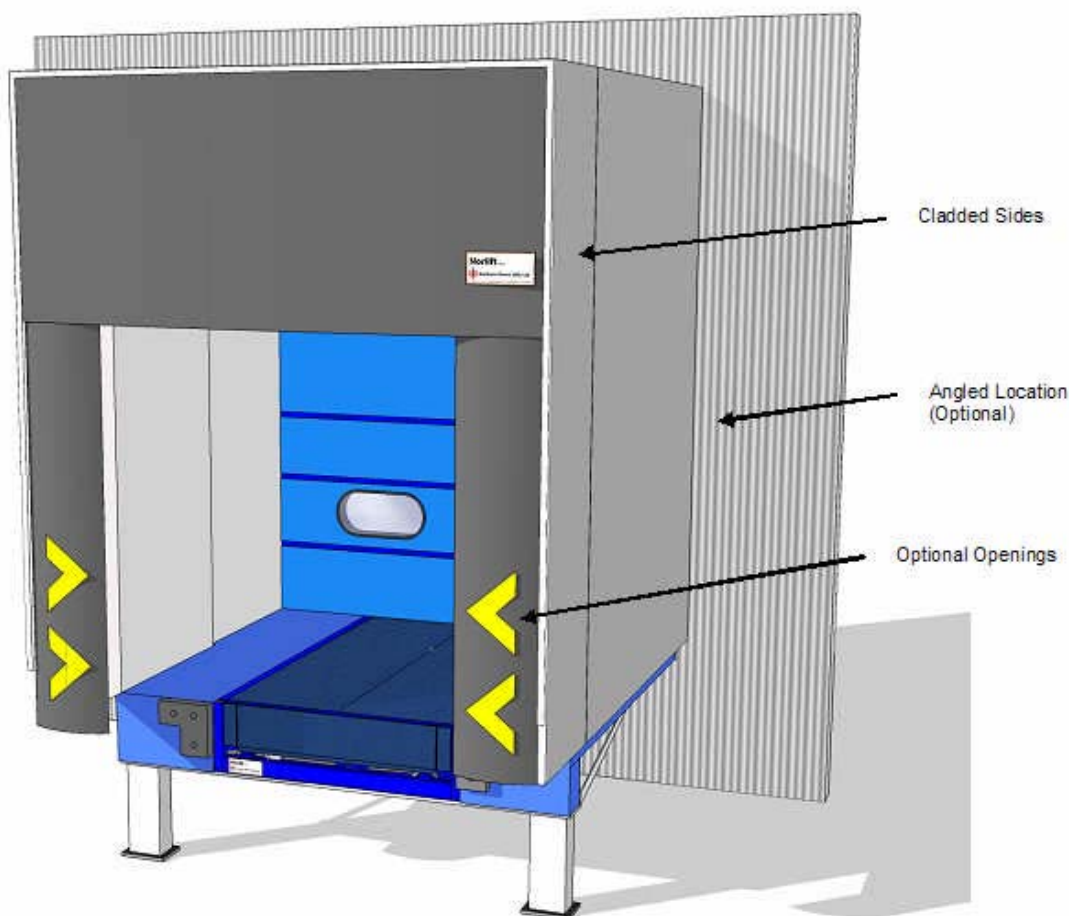

Features

Can be designed to accommodate all types of loading bay equipment, telescopic dock levellers.

Choice of retractable, foam cushion or inflatable dock shelters
Manual or electric operated sectional door or roller shutter.

Easily added to existing building.

Cost effective method of adding a loading bay facility to an existing building.
Minimum disruption to operations whilst installation is carried out.

Energy savings can be achieved by the addition of insulated cladding with insulated panels
Fast on site installation.

Loading houses can be positioned at an angle to the building especially useful where there are restrictions to the outside loading area.



Loading Bay Equipment

Repairs

It is inevitable at some stage clients loading bay equipment will become damaged, such as accidental impact. Our fleet of modern repair and service vehicles are on call 24 hours a day.

Each van is extensively stocked with replacement parts.

All our vehicles are monitored from our head office using the latest vehicle tracking system. Ensuring a repairs team is located within the geographical area and re-routed in the least possible time.



Maintenance Contracts

By having a planned maintenance contract the chances of having a product breakdown reduces significantly. Valuable time and money be saved by avoiding such an occurrence.

Any wear and tear can be identified early before any breakdown can occur. Ensuring the product is working/performing at its optimum level.

Our maintenance contracts are fully compliant with current health and safety regulations

Contact our service / repair department who will be happy to discuss your requirement and provide you with a written quota-

ASTECH - ASia Technology Corporation
Tel: +84-8-54102755
Fax: +84-8-54101845
Email: service@astech-vn.com